

# CLAMPBRO®



## 1.5 TONNE AXLE STAND

MODEL NO: CAX3TA

PART NO: 7600030

## INSTRUCTIONS

CE

GC0219 - ISS 2

# GUARANTEE

This product is guaranteed against faulty manufacture for a period of 12 months from the date of purchase. Please keep your receipt which will be required as proof of purchase.

This guarantee is invalid if the product is found to have been abused or tampered with in any way, or not used for the purpose for which it was intended.

Faulty goods should be returned to their place of purchase, no product can be returned to us without prior permission. This guarantee does not effect your statutory rights

# SAFETY WARNINGS

- Read these instructions carefully before use.
- Do not exceed the axle stands maximum load (1500 kg each / 3000 kg per pair), The vehicle weight will be stated in the owners manual.
- Use only as specified in this manual.
- NEVER let children play in or around a vehicle that is on axle stands.
- ALWAYS make sure that before you work below the vehicle, a responsible person is aware in case of injury or accident.
- Do not use more than one pair of axle stands.
- Replace the warning label if it becomes unreadable.
- Use only on a hard, flat surface, for example concrete.
- Make sure that you chock all the wheels that remain on the ground.
- Make sure that the supported vehicle cannot move.
- Set each axle stand below an appropriate point on the vehicle - See your vehicle owners manual for advice.
- Take care when using the axle stands on a three-wheeled vehicle or trailer.
- Use stands as a matched pair to support one end of a vehicle only.
- For your safety, do not modify these axle stands.

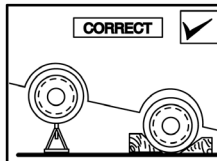
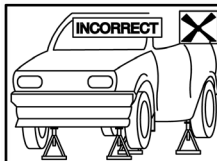
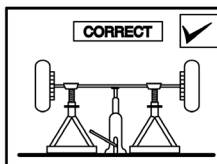
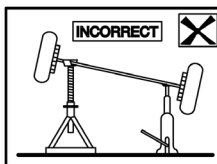

**WARNING: NEVER WORK UNDER A VEHICLE SUPPORTED ONLY BY A JACK.**



**WARNING: AFTER LIFTING THE VEHICLE, SUPPORT IMMEDIATELY WITH PROPERLY RATED AXLE STANDS**

## ASSEMBLY

1. Slide the lower column into the base.
2. Secure in place using the spring washer and bolt as shown on the right.

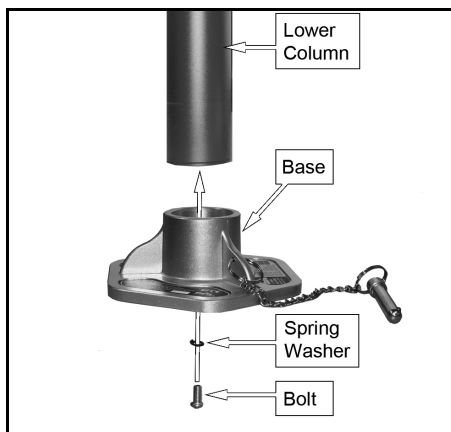

## USING THE AXLE STANDS



**WARNING: BEFORE USE, MAKE SURE THAT THERE IS NO DAMAGE TO ANY PART OF THE AXLE STAND, IF THERE IS, DO NOT USE.**

**WARNING: DO NOT EXCEED THE RATED LOAD OF 3000 KG PER PAIR OR 1500 KG PER STAND.**

**WARNING: USE ONLY ON A HARD, FLAT SURFACE, E.G. CONCRETE.**

**WARNING: IT MUST BE ENSURED THAT THE VEHICLE/LOAD IS CAREFULLY LOCATED ONTO THE CENTRE OF THE AXLE STAND SADDLE. FAILURE TO DO THIS CAN RESULT IN DAMAGE TO THE AXLE STANDS, LOSS OF SUPPORT TO THE LOAD, SERIOUS PERSONAL INJURY OR LOSS OF LIFE.**

1. Refer to the vehicle handbook for the correct jacking procedure and location of support points.
2. Raise the vehicle using a suitable lifting jack.

### ADJUST THE AXLE STAND

1. Remove the locking pin (if fitted).
2. Raise the upper column to the required height and replace the locking pin.
3. Position the axle stand under a suitable supporting point. See your vehicle manual for the location.

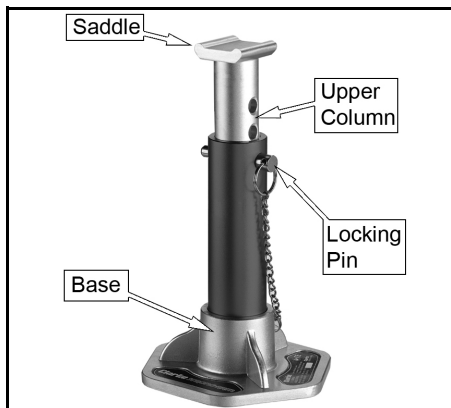

## LOWERING THE VEHICLE

1. Slowly lower the vehicle onto the centre of the saddle.



**WARNING: DO NOT LOAD THE STANDS OFF CENTRE. FAILURE TO HEED THIS WARNING MAY CAUSE DAMAGE, INJURY OR LOSS OF LIFE.**

## TO REMOVE THE AXLE STANDS

1. Raise vehicle clear of the axle stands.
2. Remove stands.
3. Ensure that all tools, equipment and personnel are clear before carefully lowering the vehicle to the ground.

## SPECIFICATION

Maximum Height	391 mm
Minimum Height	266 mm
Maximum Load	3000 kg per pair or 1500 kg per stand
Product Weight	4.6 kg per pair

## A SELECTION FROM THE VAST RANGE OF

# Clarke®

### QUALITY PRODUCTS

#### **AIR COMPRESSORS**

From DIY to industrial, Plus air tools, spray guns and accessories.

#### **GENERATORS**

Prime duty or emergency standby for business, home and leisure.

#### **POWER WASHERS**

Hot and cold, electric and engine driven - we have what you need

#### **WELDERS**

Mig, Arc, Tig and Spot. From DIY to auto/industrial.

#### **METALWORKING**

Drills, grinders and saws for DIY and professional use.

#### **WOODWORKING**

Saws, sanders, lathes, mortisers and dust extraction.

#### **HYDRAULICS**

Cranes, body repair kits, transmission jacks for all types of workshop use.

#### **WATER PUMPS**

Submersible, electric and engine driven for DIY, agriculture and industry.

#### **POWER TOOLS**

Angle grinders, cordless drill sets, saws and sanders.

#### **STARTERS/CHARGERS**

All sizes for car and commercial use.